

# **Pressgel Insulations Private Limited**

## **EPOXY CAST RESIN PRODUCTS**

*WE HAVE BEEN MANUFACTURING THESE ITEMS SINCE 32 YEARS*

### **INSULATORS**

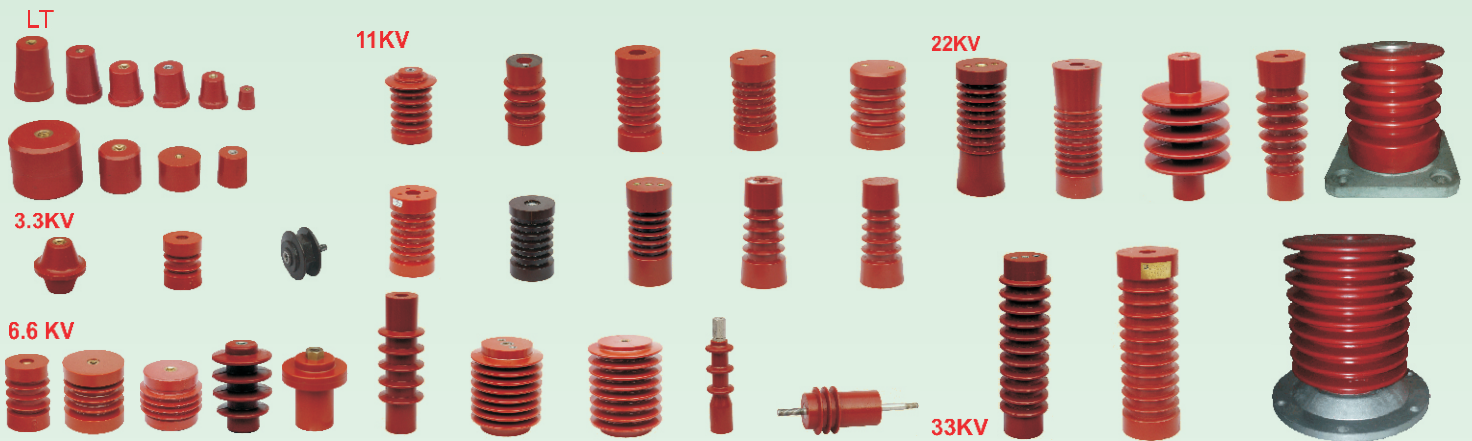

### **BUSHINGS**

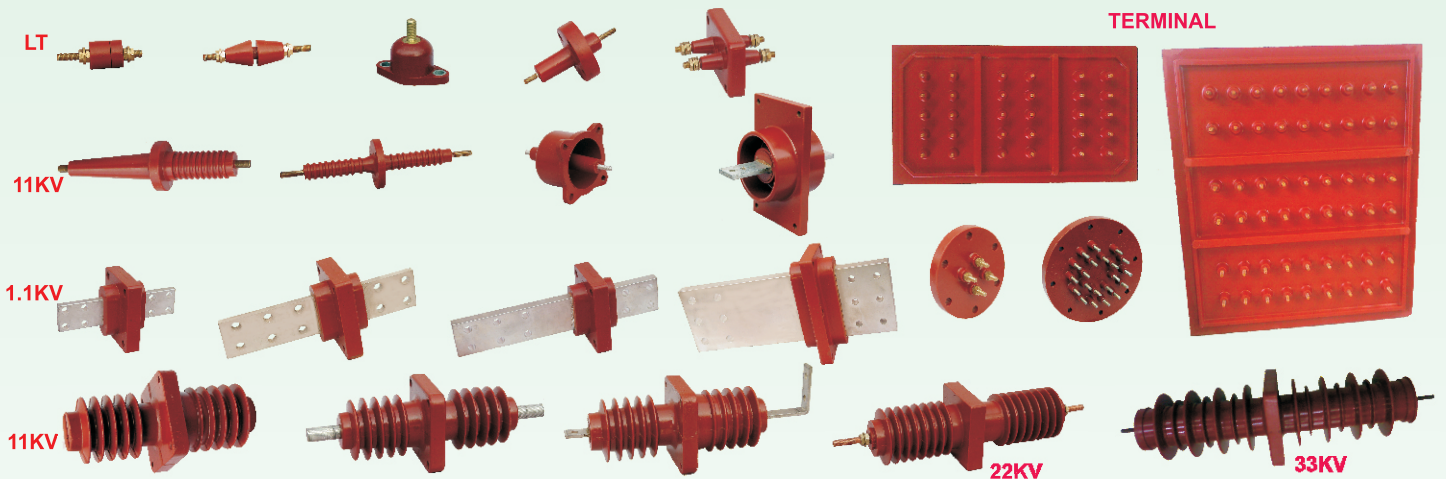

For Transformer & Switchgear Industry  
Excellent Electrical, Mechanical & Thermal Properties  
Suitable For All Media Like Air, Oil & SF6

## HV INSULATOR DETAILS

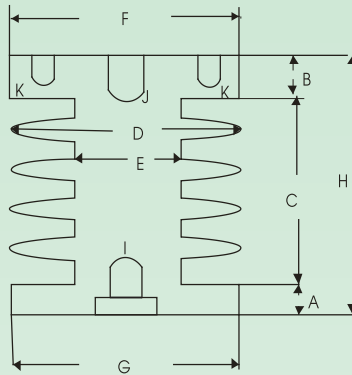

Sr. No.	Code	Creepage in mm	No of Petticoats	KV Rating	A mm	B mm	C mm	D mm	E mm	F mm	G mm	H mm	Insert (mm)			Cantilever Strength (Kg)	Weight (Kg)
													I	J	K		
1	PG-475	104	2	3.3	21	19	35	60	45	61	61	75	12	10	6	500	0.450
2	PG-008	225	4	3.3	21	12	79	78	40	43	43	112	10	10	-	500	0.550
3	PG-490	138	3	6.6	18	21	51	62	45	61	61	90	12	10	6	500	0.500
4	PG-890	150	3	6.6	18	20	52	89	66	89	89	90	12	10	6	500	1.000
5	PG-079	180	4	6.6	31	32	67	65	40	55	55	130	16	10	8	500	0.750
6	PG-4975	178	5	11	27	19	84	57	45	61	61	130	16	10	6	550	0.750
7	PG-095	178	4	11	30	32	68	78	55	71	71	130	20	16	10	700	1.100
8	PG-2338	183	5	11	34	23	69	72	58	72	72	130	20	-	8	1000	1.100
9	PG-701	190	5	11	23	23	84	75	58	80	77	130	20	16	10	800	1.100
10	PG-151	165	3	11	21	27	82	95	79	95	95	130	20	-	10	1000	1.750
11	PG-1020	185	5	11	27	28	75	81	66	83	76	130	20	16	10	850	1.200
12	PG-050	237	5	11	47	36	82	74	55	77	77	165	20	10	10	800	1.400
13	PGC-10	228	4	11	40	41	94	64	48	67	52	175	12	16	-	600	1.100
14	PGC-15	228	4	11	40	43	92	71	55	77	61	175	16	-	6	700	1.100
15	PGC-290	290	5	11	50	52	118	74	50	50	50	220	12	12	-	500	1.150
16	PG-045	250	5	22	47	49	82	74	55	77	77	178	20	-	M8x4	800	1.400
17	PG-390	586	5	22	53	52	115	134	50	50	50	220	12	12	-	500	1.950
18	PGC-20	355	6	22	42	41	142	84	55	77	60	225	16	-	6	800	1.400
19	PG-027	410	11	33	37	30	233	97	81	98	98	300	24	16	10	1200	3.450
20	PG-030	450	8	33	20	10	180	161	129	120	120	210	20	20	-	1500	5.750
21	PG-ABB	355	8	11	13	15	112	118	84	84	84	140	20	16	10	1000	2.100
22	PG-296	245	6	11	21	25	84	76	54	77	77	130	20	16	10	800	1.100
23	PG-4978	200	5	11	22	27	81	66	50	68	68	130	16	-	8	700	0.700
24	PG-210HT	290	8	22	-	20	190	83	-	85	85	210	20	16	10	1000	1.950
25	PG-230HT	310	8	22	-	40	190	83	-	85	85	230	20	16	10	1000	2.100
26	PG-031	380	7	12	24	24	102	132	90	90	90	150	20	-	16	1000	2.800
27	PG-02	410	11	33	42	42	216	85	64	70	70	300	16	10	8	850	2.600
28	PG-476	100	1	3	27	25	35	72	60	75	75	87	16	16	10	750	0.750
29	PG-297	220	5	11	24	20	86	74	59	77	77	130	20	16	10	800	1.100
30	PG-028	490	12	33	30	26	240	99	76	100	100	300	20	16	10	1000	3.100
31	PG-4980	182	4	15	63	30	55	67	53	69	69	150	16	12	-	550	1.100
32	PG-201	395	4	24	50	50	145	181	119	70	180	195	-	18	-	1500	15.250
33	PGCS-033	250	8	12	22	23	83	83/88	61/66	75	82	130	20	16	10	1000	1.450
34	PG-032	490	9	24	30	30	160	160	120	160	160	230	-	-	12	3800	6.500
35	PG-477	55	1	3.3	15	15	20	50	-	50	50	50	16	16	-	500	0.250
36	PGR1-127	205	5	11	17	35	75	62	42	62	62	127	12	12	-	500	0.750
37	PGR2-185	278	5	11	17	93	74	62	42	40	62	185	12	12	-	500	0.950

## LT-EPOXY INSULATOR

SR.NO	Code	H Height mm	D Bottom Dia mm	D Top Dia mm	Insert Size mm
1	PG-01	16	13.5	13	M3 X 7
2	PG-02	30	32	30	M8 X 15
3	PG-03	40	40	33	M8 X 15
4	PG-04	40	40	30	M10 X 15
5	PG-05	50	50	40	M12 X 20
6	PG-06	60	50	40	M12 X 20
7	PG-07	70	50	40	M12 X 20
8	PG-08	70	68	64	M10 X 16
9	PG-CY01	40	60	60	M10 X 8
10	PG-CY02	60	60	60	M16 X 10
11	PG-CY03	80	100	100	M20 X 15
12	PG-CY-04	40	60	60	M10x15

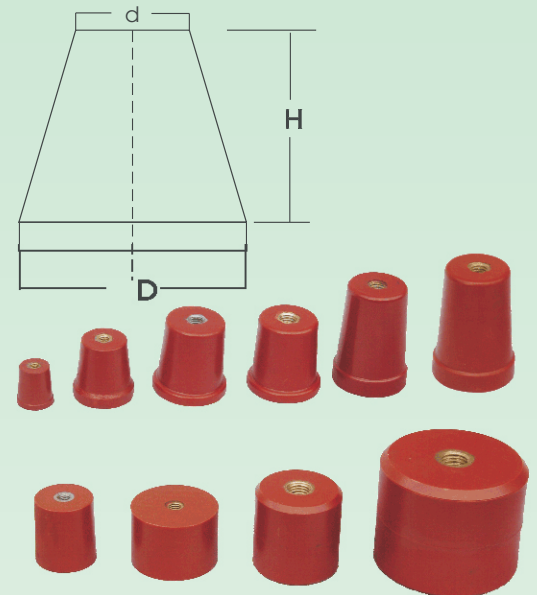

## L.V. BUSHING CHART

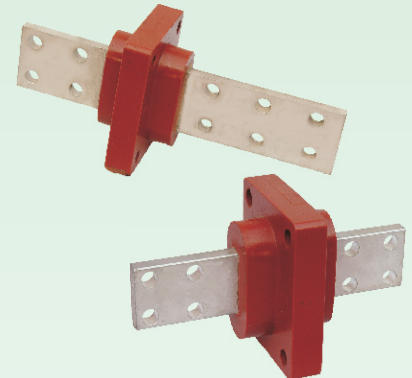
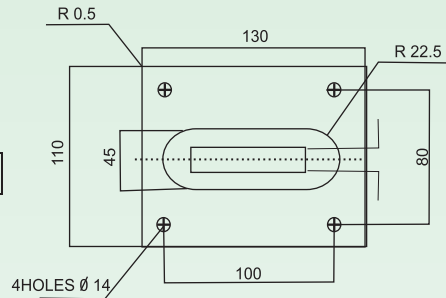
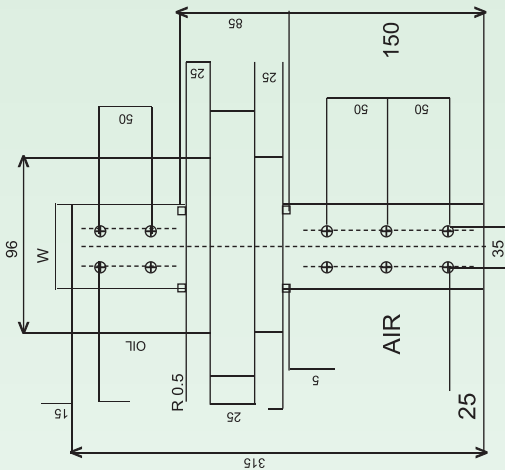

Sr. No.	Code No.	Item & Drg No.	Copper Flat
1	PGB-037	Epoxy Bushing 1Kv/1000 Amps EPB 1000/1250225	12x50x225
2	PGB-038	Epoxy Bushing 1Kv/1000 Amps EPB 1000/1250315	12x50x315
3	PGB-039	Epoxy Bushing 1Kv/1250 Amps EPB 1250/1263315	12x63x315
4	PGB-040	Epoxy Bushing 1Kv/2000 Amps EPB 2000/1963315	19x63x315
5	PGB-041	Epoxy Bushing 1Kv/2000 Amps EPB 2000/1963365	19x63x365
6	PGB-042	Epoxy Bushing 1Kv/2000 Amps EPB 2000/1963395	19x63x395
7	PGB-043	Epoxy Bushing 1Kv/3150 Amps EPB 3150/2576415	25x76x415
8	PGB-044	Epoxy Bushing 1Kv/3150 Amps EPB 3150/2576360	25x76x360
9	PGB-048	Epoxy Bushing 1Kv/630 Amps EPB 630/850225	8x50x225

We are manufacturer of L.V. Bushing from 630 Amps to 6300 Amps

